

FORM NO 1.

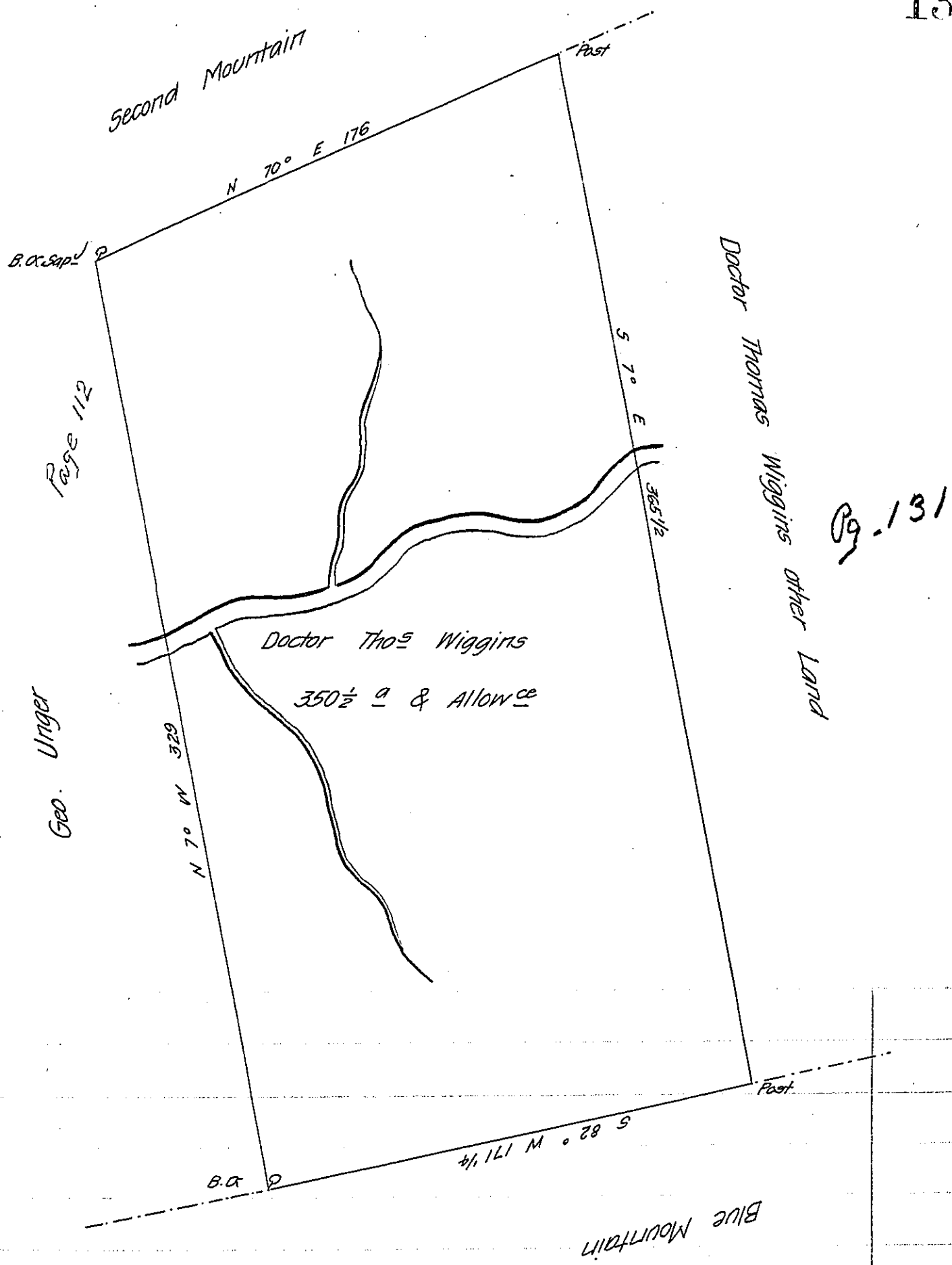

Surveyd on the 20<sup>th</sup> December 1792 for Thomas Wiggins the above dis-  
 cribed tract of three hundred fifty acres a half & Allow<sup>ce</sup> situate in Lower and  
 Middle Paxton Townships Dauphin County by his Warrant 27<sup>th</sup> February 1792

Daniel Brodhead Esq<sup>r</sup>  
 Surveyor General

Bartrem Galbraith D.S.

IN TESTIMONY that the above is a copy of the original remaining on file in  
 the Department of Internal Affairs of Pennsylvania, made  
 conformably to an Act of Assembly approved the 16th day of  
 February, 1833, I have hereunto set my Hand and caused  
 the Seal of said Department to be affixed at Harrisburg,  
 this twelfth day of January 1908

*Henry Hoveck*  
 Secretary of Internal Affairs.